

# SILVER WHISPER – Deck Plans

Effective from December 20, 2018

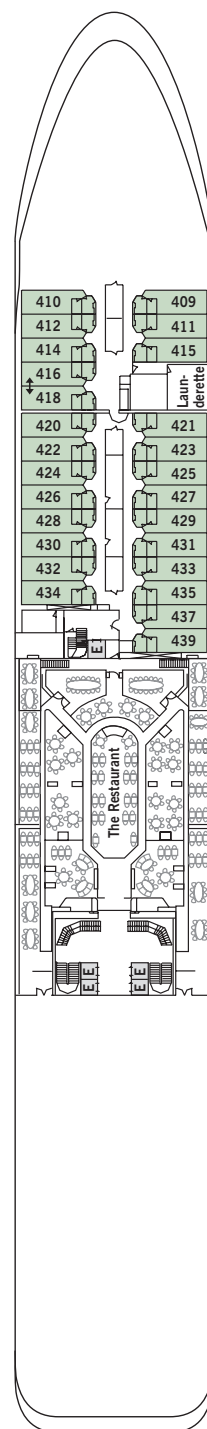

**DECK 4**

The Restaurant

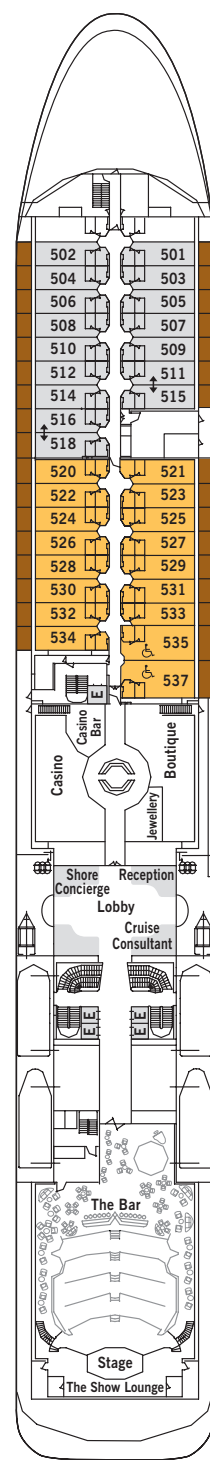

**DECK 5**

Casino  
Casino Bar  
The Bar  
Boutique  
Reception/Guest Relations  
Shore Concierge  
Cruise Consultant  
The Show Lounge

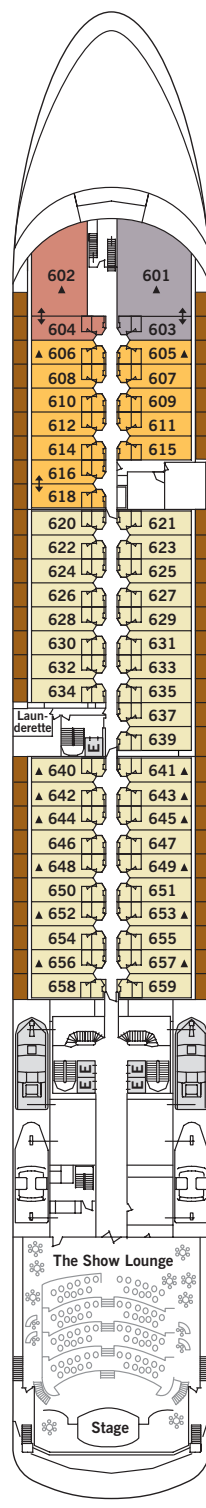

**DECK 6**

The Show Lounge

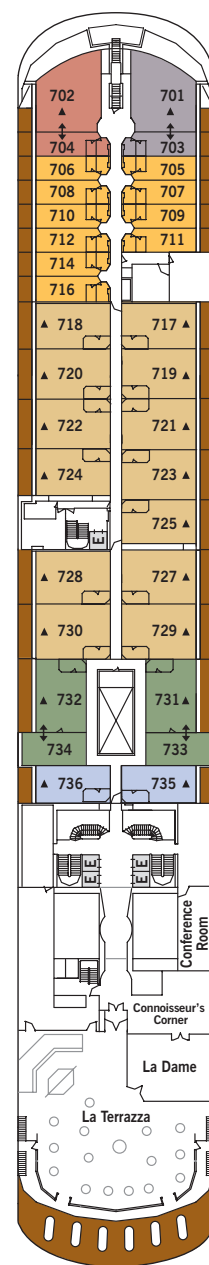

**DECK 7**

La Terrazza  
La Dame  
Connoisseur's Corner  
Conference/Card Room

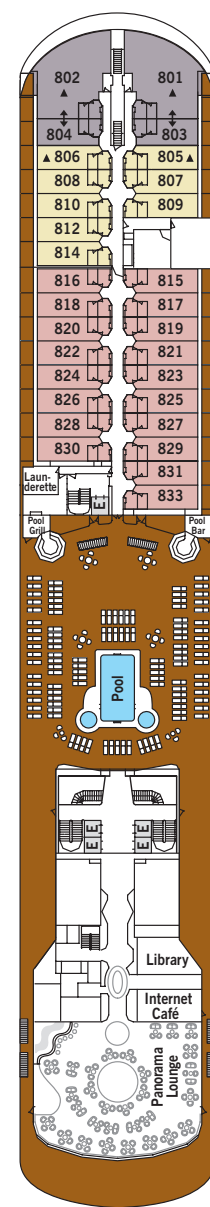

**DECK 8**

Pool Deck  
Pool Bar  
The Grill  
Library  
Internet Corner  
Panorama Lounge

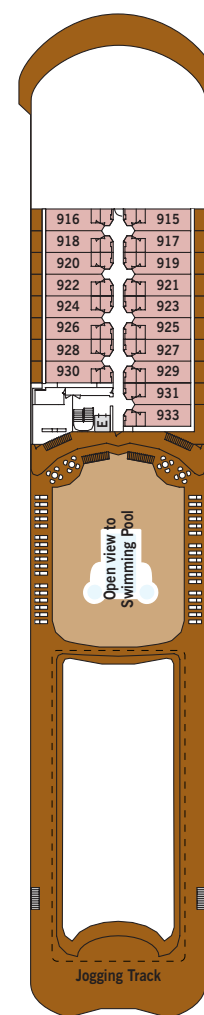

**DECK 9**

Jogging Track

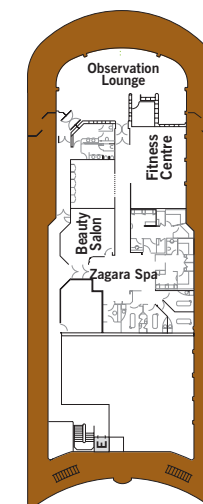

**DECK 10**

Fitness Centre  
Zagara Beauty Spa  
Observation Lounge

## SUITE CATEGORIES

- Owner's Suite . . . . .
- Grand Suite . . . . .
- Royal Suite . . . . .
- Silver Suite . . . . .
- Medallion Suite . . . . .
- Veranda 4. . . . .
- Veranda 3. . . . .
- Veranda 2. . . . .
- Veranda 1. . . . .
- Vista Suite . . . . .

## SPECIFICATIONS

- Crew . . . . . 302
- Officers . . . . . European
- Guests . . . . . 388
- Tonnage . . . . . 28,258
- Length . . . . . 610 Feet/186 Metres
- Width . . . . . 81.8 Feet/24.9 Metres
- Speed . . . . . 18.5 Knots
- Passenger Decks. . . . . 7
- 3rd Guest Capacity . . . . . ▲
- Connecting Suites . . . . . ▲
- 416/418, 511/515, 516/518, 602/604,  
601/603, 616/618, 731/733, 732/734,  
702/704, 701/703, 802/804, 801/803
- Handicap Suites . . . . . ♿
- 535,537
- Built. . . . . 2001
- Registry. . . . . Bahamas

Deckplans are for illustration purposes only and may be subject to change

Suite diagrams shown are for illustration purposes only and may vary from actual square footage. Please refer to suite specifications for square footage.

REVISED DEC 18, 2018

# SILVER WHISPER – Suite Diagrams

All suites feature:

- Butler service
- Refrigerator and bar setup stocked with your preferences
- BVLGARI® bath amenities, plus a choice of other European brands
- Plush bathrobe and slippers
- Personalised stationery
- Umbrella
- Complimentary Wifi for all suites
- Direct-dial telephone(s)



## OWNER'S SUITE

Available as a one-bedroom configuration or as two-bedrooms (as illustrated) by adjoining with a Vista Suite.

**ONE BEDROOM: 919 SQ. FT. / 85 M<sup>2</sup>**  
INCLUDING VERANDA (220 SQ. FT. / 20 M<sup>2</sup>);

**TWO BEDROOM: 1,264 SQ. FT. / 117 M<sup>2</sup>**  
INCLUDING VERANDA (220 SQ. FT. / 20 M<sup>2</sup>)

- Large teak veranda with patio furniture and floor-to-ceiling glass doors; bedroom two has additional large picture window
- Living room with sitting area; bedroom two has additional sitting area
- Separate dining area and bar
- Twin beds or queen-sized bed; bedroom two has additional twin beds or queen-sized bed
- Marble bathroom with double vanity, separate shower and full-sized whirlpool bath, plus a powder room; bedroom two has additional marble bathroom with full-sized bath
- Walk-in wardrobe(s) with personal safe
- Vanity table(s) with hair dryer
- Writing desk(s)
- Flat-screen television(s) with Interactive Media Library
- Bose® audio system
- Illy® espresso machine
- Unlimited Premium Wifi



## GRAND SUITE

Available as a one-bedroom configuration or as two-bedrooms (as illustrated) by adjoining with a Veranda Suite.

**ONE BEDROOM: 941-1,090 SQ. FT. / 87-101 M<sup>2</sup>**  
INCLUDING VERANDA (103-116 SQ. FT. / 10-11 M<sup>2</sup>);

**TWO BEDROOM: 1,286-1,435 SQ. FT. / 119-133 M<sup>2</sup>**  
INCLUDING VERANDA (163-176 SQ. FT. / 16-17 M<sup>2</sup>)

- Large teak veranda with patio furniture and floor-to-ceiling glass doors; bedroom two has additional veranda
- Living room with sitting area; bedroom two has additional sitting area
- Separate dining area and bar
- Twin beds or queen-sized bed; bedroom two has additional twin beds or queen-sized bed
- Marble bathroom with double vanity, separate shower and full-sized whirlpool bath, plus a powder room; bedroom two has additional marble bathroom with full-sized bath
- Walk-in wardrobe(s) with personal safe
- Vanity table(s) with hair dryer
- Writing desk(s)
- Flat-screen television(s) with Interactive Media Library
- Bose® audio system
- Illy® espresso machine
- Unlimited Premium Wifi



## ROYAL SUITE

Available as a one-bedroom configuration or as two-bedrooms (as illustrated) by adjoining with a Veranda Suite.

**ONE BEDROOM: 967-1,007 SQ. FT. / 90-94 M<sup>2</sup> INCLUDING VERANDA (110-116 SQ. FT. / 10-11 M<sup>2</sup>);**

**TWO BEDROOM: 1,312-1,352 SQ. FT. / 122-126 M<sup>2</sup>**  
INCLUDING VERANDA (170-176 SQ. FT. / 16-17 M<sup>2</sup>)

- Large teak veranda with patio furniture and floor-to-ceiling glass doors; bedroom two has additional veranda
- Living room with sitting area; bedroom two has additional sitting area
- Separate dining area and bar
- Twin beds or queen-sized bed; bedroom two has additional twin beds or queen-sized bed
- Marble bathroom with double vanity, separate shower and full-sized whirlpool bath, plus a powder room; bedroom two has additional marble bathroom with full-sized bath
- Walk-in wardrobe(s) with personal safe
- Vanity table(s) with hair dryer
- Writing desk(s)
- Flat-screen television(s) with Interactive Media Library
- Bose® audio system
- Illy® espresso machine
- Unlimited Premium Wifi



## SILVER SUITE

Silver Suites accommodate three guests.

**653-701 SQ. FT. / 61-65 M<sup>2</sup>**  
INCLUDING VERANDA (110-123 SQ. FT. / 10-11 M<sup>2</sup>)

- Teak veranda with patio furniture and floor-to-ceiling glass doors
- Living room (with convertible sofa to accommodate an additional guest)
- Sitting area
- Separate dining area
- Twin beds or queen-sized bed
- Marble bathroom with double vanity, separate shower and full-sized whirlpool bath
- Walk-in wardrobe with personal safe
- Vanity table with hair dryer
- Writing desk
- Flat-screen television(s) with Interactive Media Library
- Bang & Olufsen® audio system
- Unlimited Premium Wifi



## MEDALLION SUITE

Medallion Suites accommodate three guests.

**521 SQ. FT. / 49 M<sup>2</sup>**  
INCLUDING VERANDA (81 SQ. FT. / 8 M<sup>2</sup>)

- Teak veranda with patio furniture and floor-to-ceiling glass doors
- Living room with sitting and dining area
- Twin beds or queen-sized bed
- Marble bathroom with double vanity, separate shower and full-sized whirlpool bath
- Walk-in wardrobe with personal safe
- Vanity table with hair dryer
- Writing desk
- Flat-screen television with Interactive Media Library
- Unlimited Premium Wifi



## VERANDA 1 - 4

Veranda Suites 605, 606, 640-645, 648, 649, 652, 653, 656 and 657 accommodate three guests. Veranda 3 and Veranda 4 offer preferred central location with identical accommodations to Veranda 1 and Veranda 2

**345 SQ. FT. / 32 M<sup>2</sup>**  
INCLUDING VERANDA (60 SQ. FT. / 6 M<sup>2</sup>)

- Teak veranda with patio furniture and floor-to-ceiling glass doors
- Sitting area
- Twin beds or queen-sized bed
- Marble bathroom with double vanity, full-sized bath, separate shower
- Walk-in wardrobe with personal safe
- Vanity table with hair dryer
- Writing desk
- Flat-screen television with Interactive Media Library
- Unlimited Standard Wifi



## VISTA SUITE

Vista Suites accommodate three guests. Vista Suite offers preferred central location with identical accommodations to Vista 1 and Vista 2

**287 SQ. FT. / 27 M<sup>2</sup>**

- Large picture window providing panoramic ocean views (Vista Suite)
- Sitting area
- Twin beds or queen-sized bed
- Marble bathroom with double vanity, full-sized bath, separate shower
- Walk-in wardrobe with personal safe
- Vanity table with hair dryer
- Writing desk
- Flat-screen television with Interactive Media Library
- Unlimited Standard Wifi

